

Digital measuring
 electronics,
 all integrated

Measuring range:

- Designed for full range measurement, 0-100%
- Factory configured by customer specification

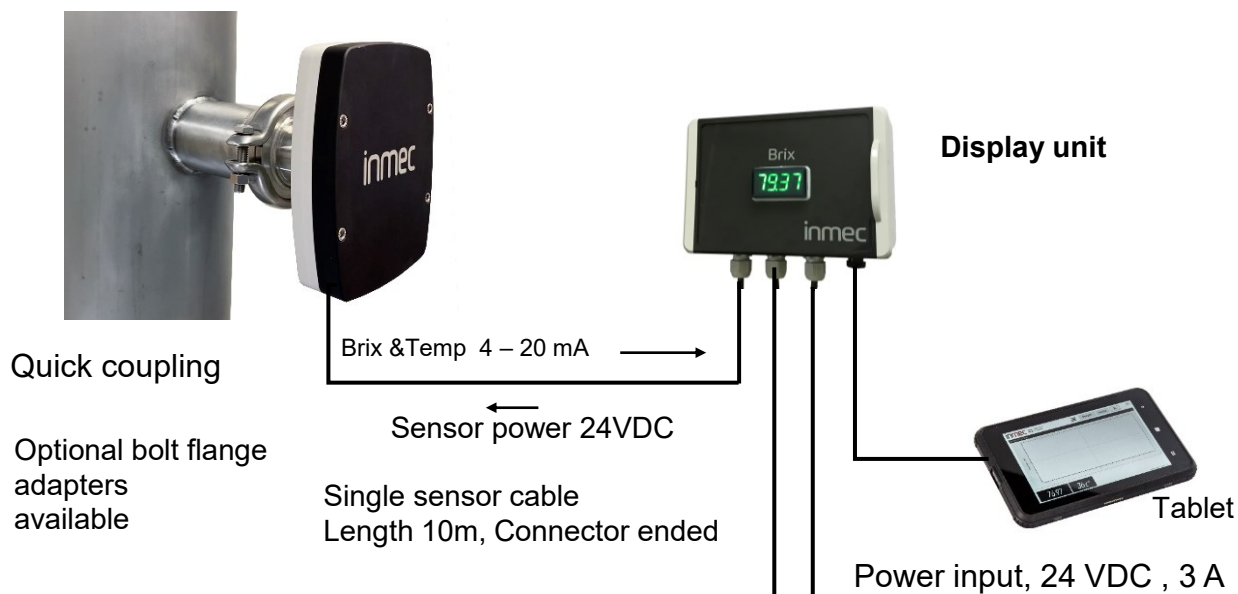

Quick coupling

Optional bolt flange
 adapters
 available

Display unit

Tablet

Power input, 24 VDC, 3 A

Installation parts



Clamp Weld ring O-ring

Optional bolt flange adapters



Brix, 4–20 mA (Active)

Temp. 4–20 mA, (Active)

RS 485 serial link to Gateway unit

I/O 2 is dedicated for either
 Process temperature output
 or Line run Digital input
 Depends on application

Sensor Model IL dimensions, mm

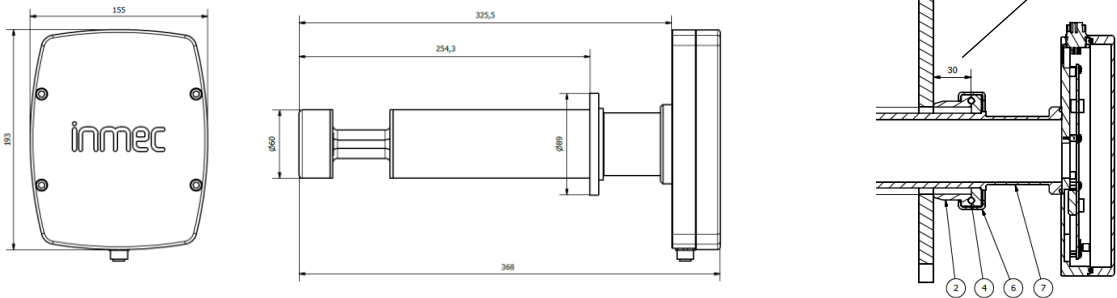

Display Unit, connections

Power and I/O CONNECTIONS			
X1			
11	+	24 VDC Main Power	To fuse
12	-	24 VDC Main Power	Blue
13	+	24 VDC to sensor	Red
14	+	Brix, 4-20 mA output Active	Pink
15	-	Brix, 4-20 mA output Active	Grey
16	+	I/O 2, Temp, 4-20 mA or Dig In 24VDC	Green
17	-	I/O 2, Temp, 4-20 mA or Dig In 24VDC	Yellow
18		4-20 mA via display to X1;16	Grey

Display unit



Tablet and Remote CONNECTIONS			
X2			
21	-	Rs-485 Remote (Gateway)	
22	-	RS-485 Local (Tablet)	Brown
23	+	Rs-485 Remote (Gateway)	
24	+	RS-485 Local (Tablet)	White

Tablet cable



Tablet

- Windows 10
- Touch screen
- In-built Cellular
- All sensor tuning functions
- Manages all sensors of a mill

Display Unit features

- Numeric Brix Display
 - Tablet cable connector
 - Sensor cable connections
 - Mill connections
- 24VDC,3A Power
 4-20mA outputs, Active; Max load 750 Ohm

Dimensions

230*130*100 mm

Sensor specifications Inmec Model IL/SRC, In-Line sensor

Measurement	Digital microwave signal formation and processing
Operating power	24VDC, 3 Amps, Continuous 2 Amps
Microwave power	15 mW
Connection	Cable to Connection unit, 8 wire shielded. Connectors Aisi316L
Process connection	Union-L coupling welded ,76.1 mm , Aisi 316L. Optional Bolt adapters
Gasket	O-ring EPDM, Viton as option
Measuring range	Factory configured to specific range by customer specification
Repeatability	+/- 0.01 % concentration
Sensitivity	+/-0.001% concentration
Measuring resolution	0.01% concentration
Output filtering	1 – 300s
Output 1	Brix output. 4 – 20 mA, Active and Isolated. Max load 750 Ohm
Output 2	Temperature output. 4 – 20 mA, Active and Isolated. Max load 750 Ohm
	Alternative: Line Run, Digital Input, 24VDC
Signal processor	DSP
Process conditions	
pH range	3 – 11
Temperature	0 – 140 C
Pressure	
Minimum	Recommended min 1.5 bar to avoid free air
Maximum	PN10 ,
Conductivity	Max. 13mS/cm
Environment	
Temperature	0 – +70 ; Protection needed in case of direct heat source
Housing	IP65
Vibration	max. 20 m/s ² 10-2000Hz
Materials	
Model IL	Sensor body, Aisi 316L. Installation weld ring Aisi 316L
Housing Parts	Aluminum, Anonized
Antennas	Ceramic
Sensor weight	3.4 kg

Display Unit specifications

Operating power	24VDC, 3 A
Connection	Cable to sensor, 10m, 8 wire shielded. Connectors Aisi316L
Environment	
Temperature	0 – +70
Housing	IP65
Material	ABS Plastic
Unit weight	1 kg
Dimensions	230*130*100 mm
Wall mount	4 bolts, Corner loops

Features:

- Numeric display of Brix, Density or %-Concentration
- I/O connections
- 24VDC, 3A power supply for the sensor
- 2 * 4 -20mA outputs forwarded from the sensor, Active and Isolated, Max. load 750 Ohm
- Alternative to second 4-20mA output: Line Run, Digital Input, 24VDC
- RS 485 serial link to external Gateway unit
- Connection to the Operating Tablet, USB-A